

House & Land Package



Package Price:
\$1,485,000*

Illustration purposes only, modifications will be required to comply with Developer Design Guidelines.

Lot 4823
Proposed Road,
Menangle Park NSW 2563

Vince Amitrano
0439 288 550
Vince.a@betterbuilthomes.com.au

BETTER LUXURY + OPULENCE PROMOTION

- Caesarstone 40mm benchtop including island bench or 20mm with waterfall ends to island bench.
- Floor tiles to entry, hallway, living, kitchen, meals & family
- Laundry soft close cabinetry fitout, including 20mm stone benchtop
- Fisher & Paykel Microwave, Oven, Cooktop & Rangehood
- Glass splashback to kitchen.
- 2600mm high ceiling to ground floor
- 1200mm wide entrance door.
- Floor tiling to porch & alfresco.
- Full Height Tiling to ALL wet areas that have a shower
- 1700mm Freestanding bath
- 2 x USB phone charging points
- Clipsal led downlights x 30
- Taubmans 3 coat paint system.
- Hills 4 zone alarm system.
- Plus much more!

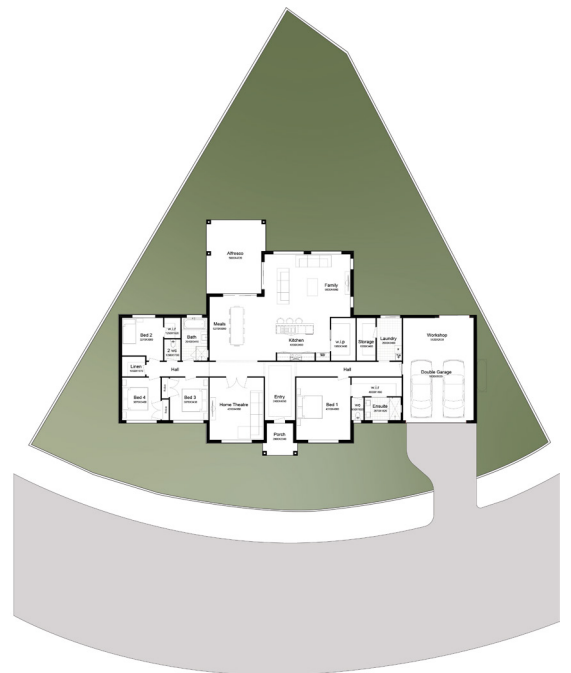

Siting shown is indicative only and is for illustrative purposes.

Package Price
\$1,485,000

Home Design: Greendale 36
 Facade: Mayberry Deluxe

LAND SIZE	855m ²		
TOTAL:	337.27m ²	Garage:	51.29m ²
Width:	28.44m	Porch:	6.08m ²
Depth:	18.75m	Alfresco:	26.57m ²
Ground Floor:	253.33m ²		



GROUND FLOOR



DISCLAIMER: Façade Images shown on our brochures may feature alternative upgrades. Upgraded finishes are not included in the standard range or house design and should be used as a guide only. Plan dimensions, sizes & square meters will vary dependent on the chosen house façade & design. Better Built Homes reserves the right to revise plans, specifications & prices without notice or obligation. All plans are Copyright of Better Built Homes. Licence No. 244242C.